

## LEAF EXPANDER SERIES<sup>(PATENTED)</sup>

The Leaf Expander series looks like a rapid palatal expander with the addition of Nickel Titanium **MEMORIA**<sup>®</sup> leaf springs. The biomechanical action of this expander series is due to the super-elastic properties of the Nickel Titanium unique leaf shaped springs, which release controlled and continuous force. Expander selection, among the 4 different combination of size and force, is decided based on the transverse discrepancy and dentition/age of the patient. The Leaf Expander reactivation is completed in the dental office according to a simple and straightforward suggested clinical protocol, while the Leaf Self Expander does not need any periodic reactivation at all.

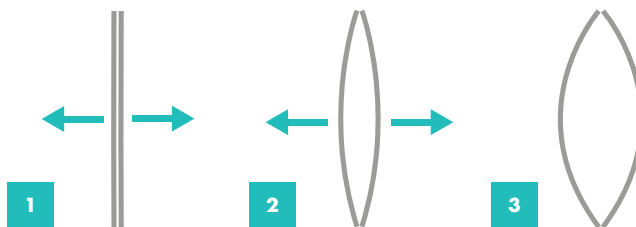

Behaviour of **MEMORIA**<sup>®</sup> LEAF springs during expansion

**- SUBSTANTIAL AND WELL-PROVEN CLINICAL RESULTS \***

**- FULL CONTROL OF THE MAXILLARY EXPANSION TREATMENT THANKS TO PREDETERMINED, CALIBRATED AND CONSTANT FORCE RELEASED BY THE LEAF SPRINGS.**



**COMPLIANCE FREE,  
NO HOME ACTIVATION REQUIRED!**

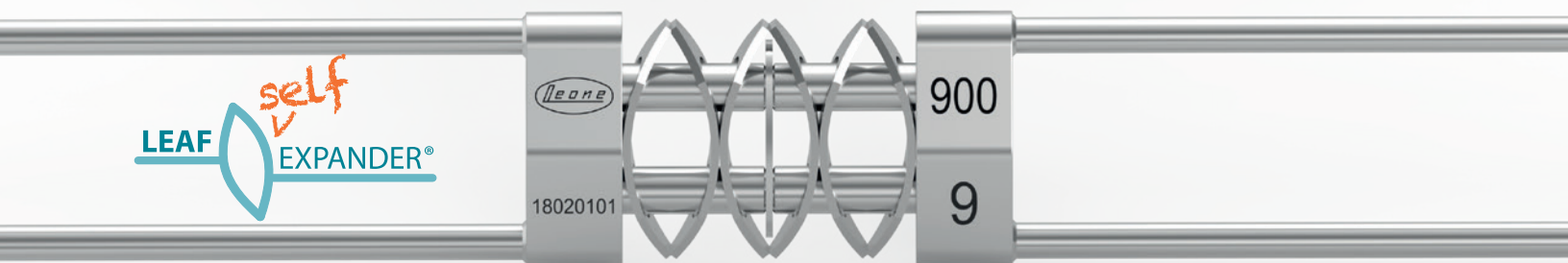

**COMPLIANCE FREE; NO MORE HASSLE  
WITH ACTIVATION, NEITHER DOMESTIC OR CLINICAL!**

\*Lanteri, C.; Beretta, M.; et al (2016). "The Leaf Expander for Non-Compliance Treatment in Mixed Dentition". The Journal of Clinical Orthodontics, Vol 50.9.  
Manzella, K.; Franchi, L.; Al-Jewair, T.; (2018). "Correction of Maxillary Transverse Deficiency in Growing Patients with Permanent Dentitions". The Journal of Clinical Orthodontics, Vol 51.3.  
Lanteri, C.; Lanteri, V.; et al (2017). "New Horizons of Maxillary Expansion in Interceptive Orthodontics". Bollettino di Informazioni Leone, Vol 100. Translated from Italian.  
Lanteri V; Beretta M., Gianolio A., Cossellu G; Farronato GP Maxillary Tridimensional Changes After Slow Expansion With Leaf Expander<sup>®</sup> in a sample of growing patients: a pilot study. European Journal of Paediatric Dentistry 19/1: 263-268 2018

# MEMORIA® LEAF SPRING ACTIVATED EXPANDER (PATENTED)

This expander looks like a rapid maxillary expander equipped with two or three Nickel Titanium **MEMORIA®** leaf springs allowing the release of calibrated and continuous forces to promote the expansion of the maxillary arch.

Re-loading is needed when the two opposing leaf springs move apart: the intraoral activation, which must be done in the dental office, will put the springs in reload again thus allowing the release of the selected force.

The expander is available in two models releasing respectively 450 g and 900 g. The package includes a special clip to keep the leaf springs compressed by facilitating the phases of work and development of treatment either for clinician or technician. Supplied with a swivel key with handle to facilitate the endoral activation by the professional. The arm bending and self-locking instrument P0620-00 (Page 48) is also available.

Packs of 1

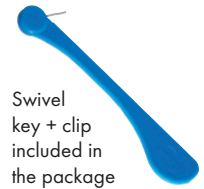

Swivel key + clip included in the package

## CLIP

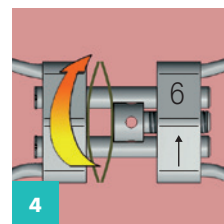
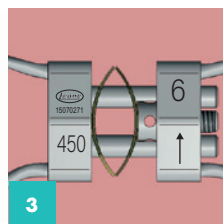
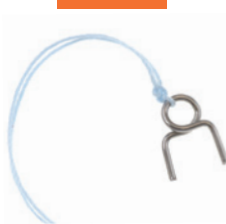
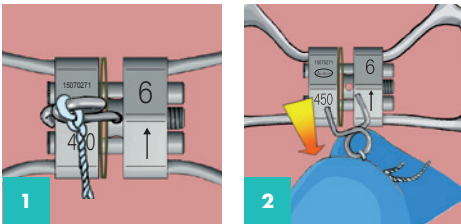

After cementing, remove the clip to activate the force of the Leaf Ni-Ti springs.

At periodic appointments, activate the expansion screw to recompress the springs, and reactivate the expansion forces.



EXPANDER ACTIVATION GUIDELINES	LEAF expander cementation	FIRST visit		SECOND visit		THIRD visit	
		spring activation	turns	spring activation	turns	spring activation	turns
<b>6 mm</b> <b>A2703-06 - A2704-06</b>	spring activation 0 turns	after 6 weeks	10 turns	after 4 weeks	10 turns	after 4 weeks	10 turns
<b>9 mm</b> <b>A2703-09 - A2704-09</b>	spring activation 0 turns	after 8 weeks	15 turns	after 6 weeks	15 turns	after 6 weeks	15 turns

## LEAF SELF EXPANDER (PATENTED)

Featuring all the advantages of the Leaf expander without the need of periodic reactivation. The work of this expander is assigned entirely to the flexible properties of the nickel titanium leaf springs releasing controlled and continuous forces. The choice of the expander is decided on the basis of the transverse discrepancy of the patient: therapy is therefore predetermined and no further action is required, nor by the clinician nor even by the patient. Available in two strength levels and two expansion capabilities to meet nearly all maxillary deficiencies. The arm bending and self-locking instrument P0620-00 (Page 48) is available. Pack of 1

